

For Installation of Lighttalk 10 Recessed Wall Light RGBW.
Model. ULA-40013 and ULA-40014

PRODUCT DRAWING (DIMENSIONS)

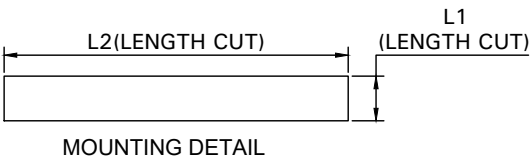

MODEL NO.	DIMENSION	
	L1(mm.)	L2(mm.)
ULA-40013	70 (2.76")	650 (25.6")
ULA-40014	70 (2.76")	1245 (49")

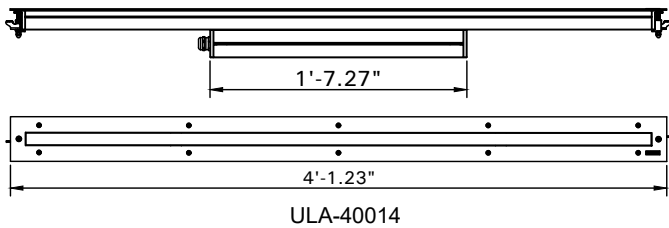
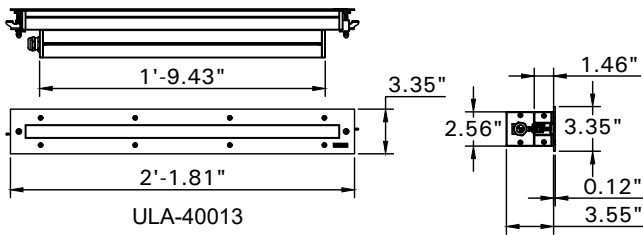
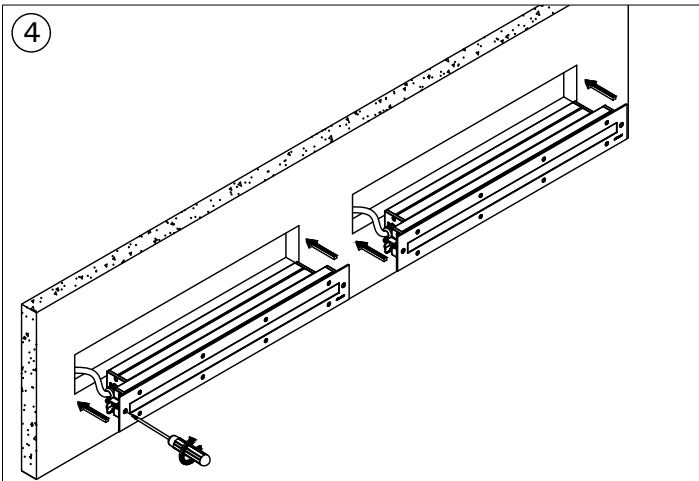
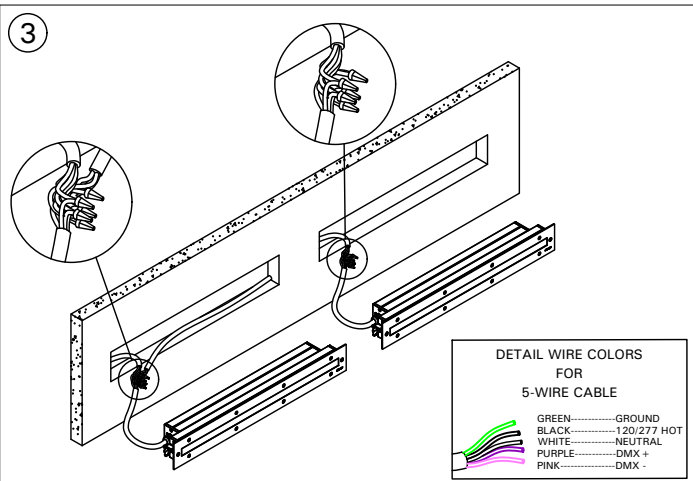
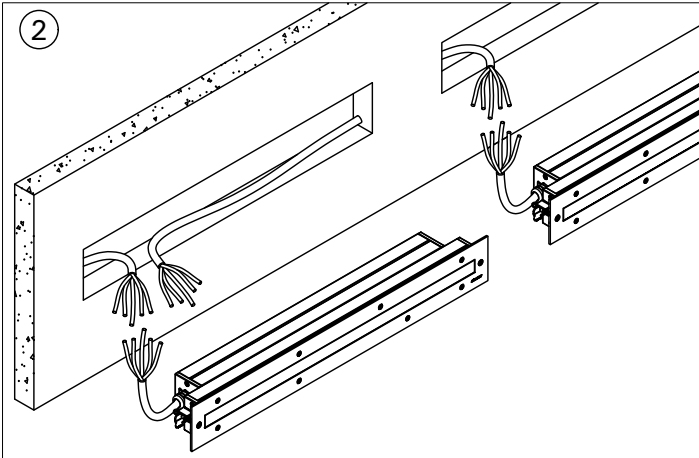
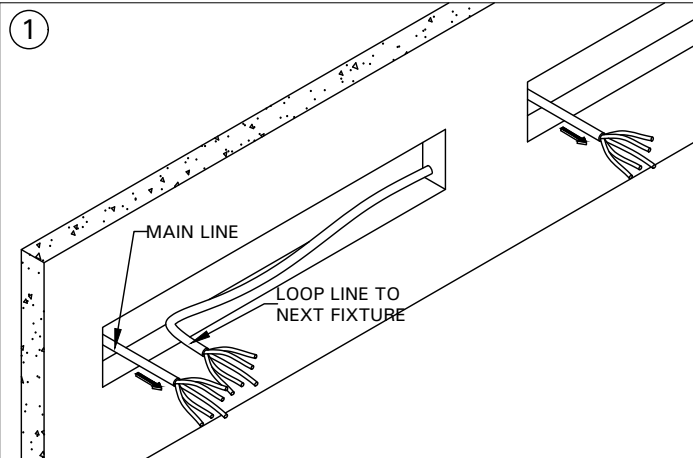

Notice to installer :

WIRING INSTRUCTIONS Warning : RISK OF FIRE AND ELECTRICAL SHOCK. : FIXTURE MUST BE INSTALLED BY A QUALIFIED ELECTRICIAN ONLY>FIXTURE IS INTENDED FOR INSTALLATION IN ACCORDANCE WITH THE NATIONAL ELECTRICAL CODE, LOCAL AND FEDERAL CODE SPECIFICATIONS. DISCONNECT POWER BEFORE SERVICING.

Ligman Lighting USA

7144 NE Progress Court, Hillsboro
Oregon, 97124, USA
Tel : 503 645 0500 | Fax : 503 645 8100

5

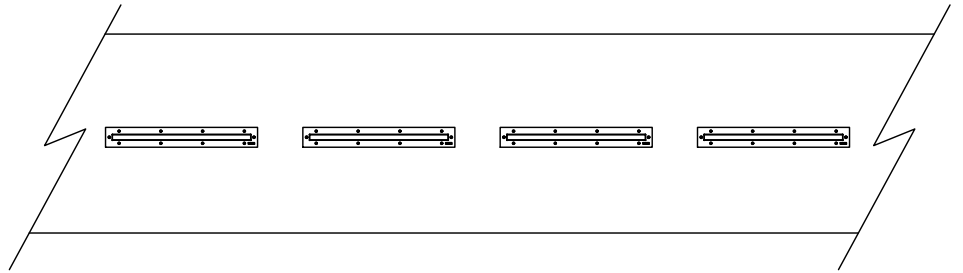
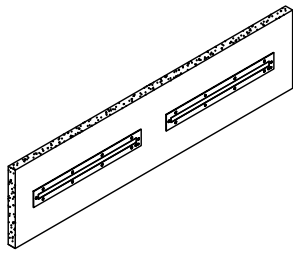

6

WIRING DIAGRAM DMX SYSTEM

TOTAL LENGTH PER OUT DOES NOT EXCEED 300m. [984ft.]

120 - 277 Vac. MAX: 32 DEVICES PER OUTPUT (MORE USING BOOSTERS OR SPLITTERS)

